

Bert Vegh Invitational Men's Meet Hosting Protocol



Bright Raven Gymnastics

Our goal is to bring out the best in each child.

Welcome to Bright Raven East - 62 School St Victor NY

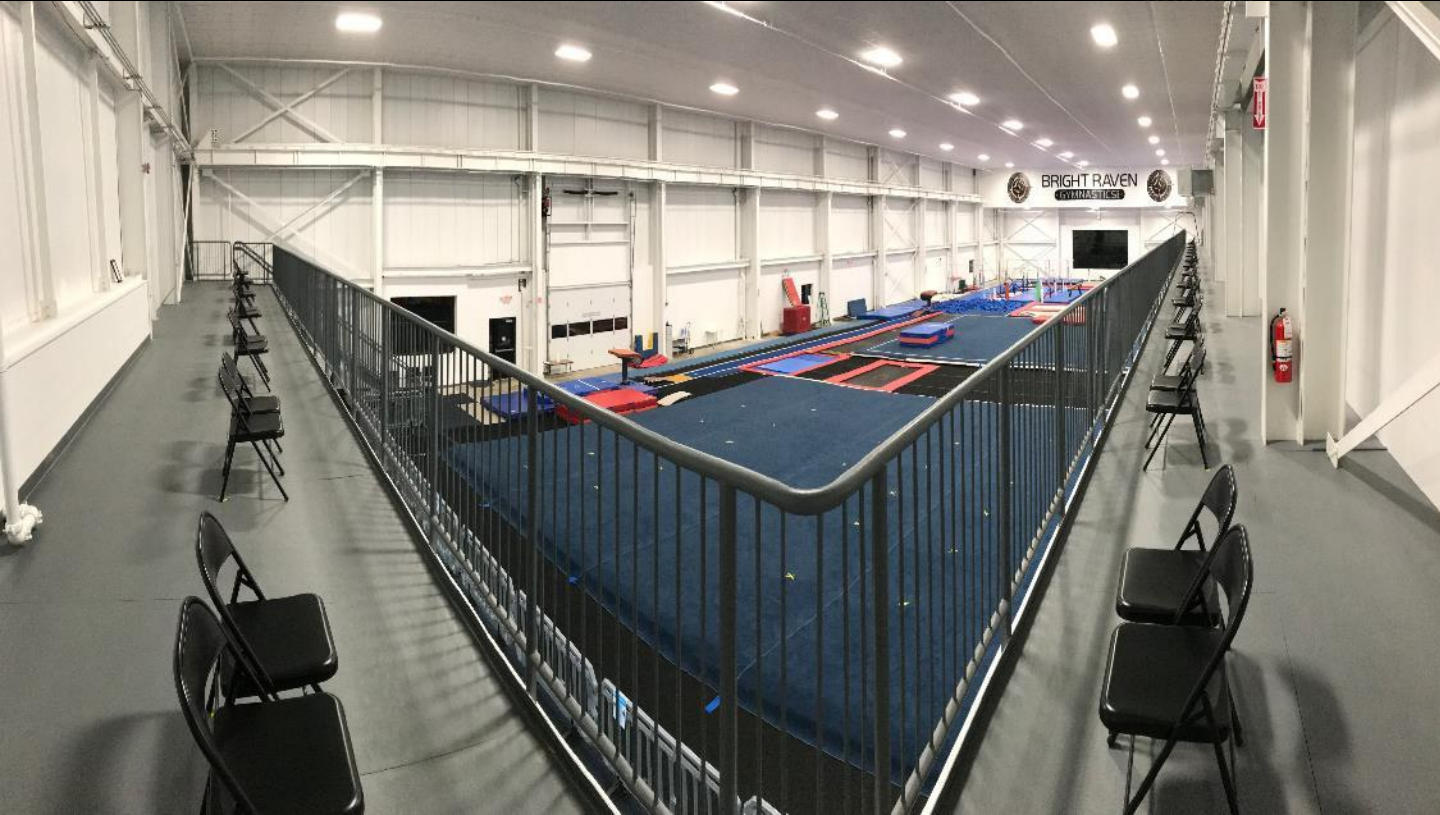

Brand New 28,000
sq ft facility

Designed to host
large competitions

All Covid protocols in
place to ensure the
safety of all

Entrance Points



Athlete/Coach Guidelines

Athletes and Coaches:

- Will complete COVID-19 screening form within 24 hours of competition
- Will enter at designated entrance
- Upon arrival, shall be given a touchless temperature check
- Athletes will be required to wear their mask at all times other than when on equipment
- Coaches must wear their masks at all times
- Will be escorted to their designated warm-up area (FX areas)
- Ample bathroom space is available within the main gym space
- Athletes arrive ready to compete to avoid congregation within bathrooms
- Individual boxed meals will be available for coaches staying for multiple sessions

Competition Management

Competition Management

- Ample spacing between equipment including two duplicate full floors
- Each squad will consist of gymnasts from the same team
- Equipment will be sanitized between each rotation
- Ample time will be scheduled between sessions for overall facility disinfection
- Each gymnast will be required to have their own water bottle and their own chalk which must be enclosed in a sealable container or bag
- The use of drinking fountains will be prohibited
- There will be no communal chalk trays
- All bathrooms have touch free soap and paper towel dispensers



Spectator Guidelines

Spectator Guidelines

**** Masks must be worn at all times ****

- Spectators will complete COVID-19 screening form within 24 hours of competition that includes contact tracing info
- 1 spectator per gymnast limit with a max total of around 36 athletes per session
- Spectators will be given a temperature check upon entrance at their designated door
- Spectators will follow the marked floor areas 6 feet apart for waiting if it is necessary before they are escorted to athlete viewing areas.

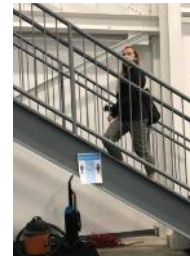

Spectator Guidelines

Spectator Guidelines Cont'd

- Spectators will be escorted to designated seating areas with numbered chairs spaced 6 feet apart.



Floor Plan for Spectator Seating



Mezzanine Seating

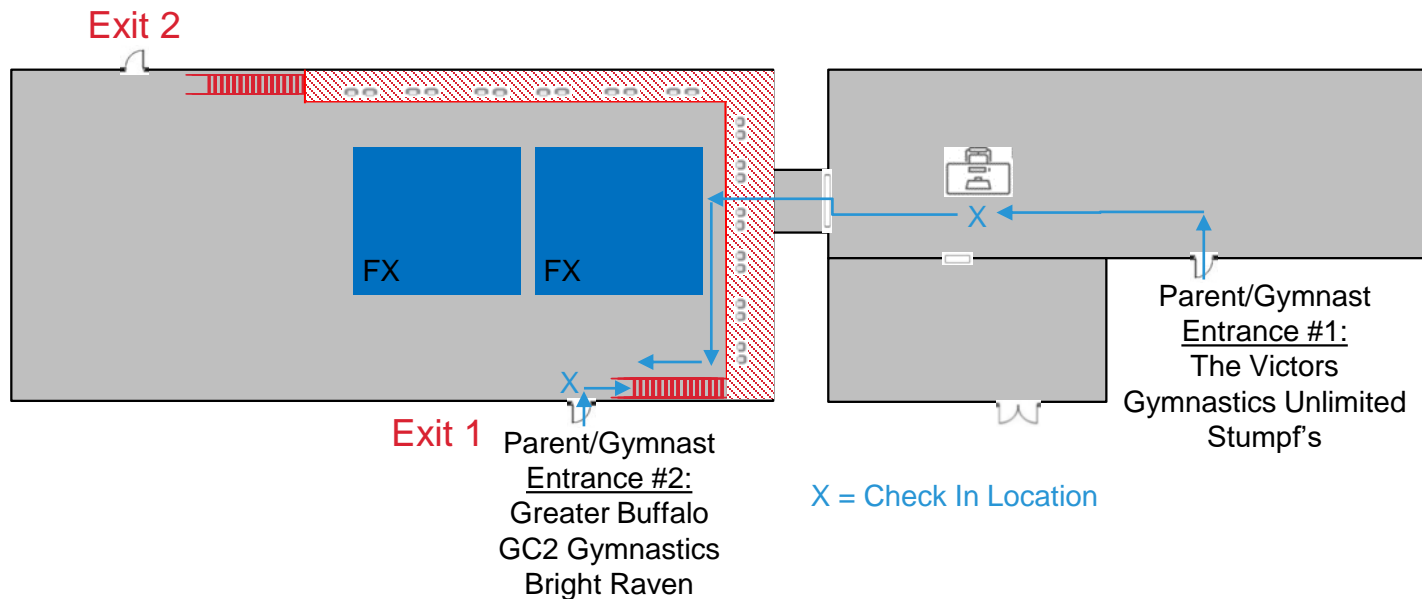

Spectator Guidelines Cont'd

Spectator Guidelines Cont'd

- Spectators will be asked to stay in their seats unless they need to use the bathroom
- No flash photography allowed
- No food or drinks allowed (except water)
- At the conclusion of the meet, spectators will follow signs to their designated exits
- Two exit doors will be used at each end of the stairwells



Judges Accommodations

Judges Accommodations

- Judges will enter through the front entrance door and will be directed to the dance studio
 - Screening questionnaire will be completed
 - Temperature will be checked
 - Masks worn at all times
- Judges report time will be after gymnasts have entered the facility
- Separate men's and women's bathrooms dedicated for Judges just outside the conference room
- Individually wrapped boxed meals will be provided for Judges



Judges Operations

Judges Operations

- Judges will be seated at individual tables during competition
- Sanitized 2-way radio headsets will be provided to each pair of Judges per event
 - to keep social distancing
 - to eliminate need for paper exchange
 - to enable communication with scoring table and meet director
- Judges will enter gymnast scores using iPads provided by gym



Award Ceremony

Live Award Ceremony

- Live competitors will receive participation awards
 - No traditional award presentation will follow the meet
 - No post meet pictures allowed within the facility
 - Individual Medals and Team Banners will be mailed to the participating gyms for distribution



Thank You!



Bright Raven Gymnastics

Our goal is to bring out the best in each child.